

KMT GENUINE PARTS

FOR SAFE AND RELIABLE OPERATION



Intensifier Parts



Cutting Heads



Diamond Orifices



Fittings & Tubing

2024 - 2025
CATALOG



kmtgenuineparts.com

KMT
WATERJET

FOR TECHNICAL SERVICE:

email: kmtgenuineservice@kmtwaterjet.com

+1 800-826-9274, Press 2



LEGEND

- Sales Manager
- Technical Service
- Customer Service



KMT Genuine Service is Closer Than you Think!

TO ORDER PARTS:

+1-800-826-9274, Press 1

+1-620-856-2151, Press 1

Fax: +1-620-856-2242

email: kmtgenuineparts@kmtwaterjet.com

Normal business hours are:

7:00AM to 5:00PM Central Time

After hours emergency help is available 24/7



ORDER KMT GENUINE PARTS ONLINE 24/7:

kmtgenuineparts.com

(Log-in required)



KMT Genuine Parts are guaranteed to be of the highest quality, ensuring that your investment is protected.

Our parts are stringently tested to deliver a healthier & more efficient waterjet system, giving you peace of mind.

THE VALUE OF KMT GENUINE PARTS

- Imitation parts DO NOT meet our stringent requirements for **QUALITY** and **SAFETY**.
- Fewer break/fix scenarios saving downtime
- Any use of non-KMT Genuine Parts on KMT equipment may reduce component lifetimes, compromise safe failure modes, and could void the Warranty
- **Fast delivery--same-day shipping on most parts**

For your convenience, we have labeled all items in this catalog according to the pressure range of their application. The following color code applies:



The product has been designed for use with our ultra-high pressure PRO product series and is applicable at a pressure range of up to 90,000psi/6.200 bar



The product is applicable at a pressure range of up to 60,000psi/4.100 bar

All dimensions in this catalog are in inch unless specified otherwise. The decimal notation can be converted as follows:

0.25 = 1/4 inch

0.38 = 3/8 inch

0.56 = 9/16 inch

0.75 = 3/4 inch

KMT products are tested & meet ISO 9001 processes and procedures with specific requirements so that our products are designed to perfectly fit with minimal installation time and for maximize usage.



Please note that all technical details shown in this catalog are subject to change and pictures are similar.

CONTENTS

KMT Pumps Portfolio 6

Intensifier Replacement Parts 8

Seal Assemblies	10
Cylinder Seals & Spacers	11
Repair Kits	11
Proximity Switch Kits	12
Hydraulic Cylinders & Heads	13
Pump Plungers	14
Liners	15
Backup Rings	16
Hydraulic Cartridge Seal Assemblies	16
Hydraulic Piston Assemblies	17
Cylinders	18
High Pressure Cylinder Nuts	19
Bushing Retainer Flanges	20
Retaining Rings	20
Miscellaneous	20

Sealing Heads 21

Sealing Head Assemblies	22
Spacers	23
Sealing Heads	24
Glands	25
Repair Kits	26

NEO Pump Kits 28

NEO 30 HP & 50 HP Kits	29
------------------------	----

Cutting Heads 30

Cutting Heads	31
Cutting Head Assemblies	32

Cutting Head Parts 33

AUTOLINE Cutting Head Assembly Components	33
Cap	34
Body	34
Wear Inserts	35
Spare Parts Kits	35
Abrasive Feed Tube Adapters	36
Abrasive Feed Tube Assembly	36
Knob Retainer	36
Abrasive Guard	36
IDE Retaining Nut	37
Focusing Tube Retaining Collet	37
Short Stop Adapter Assembly	37

Orifices & Focusing Tubes 38

Orifices for 60,000psi Abrasive Cutting	39
Orifices for 90,000psi Abrasive Cutting	40
Orifices for 60,000psi Water-only Cutting	41
Orifices for 90,000psi Water-only Cutting	43
Focusing Tubes	44
SHAPE Delta Focusing Tubes	46

Pneumatic Valves 48

Pneumatic Valve / Actuator Assemblies	50
---------------------------------------	----

CONTENTS

Repair Kits
51

Tool Kits
52

Pneumatic Valve Bodies
52

Actuators
53

Nozzle Nuts
54

Valve Glands
55

Nozzle Tubes
56

HP Fittings & Tubing 59

Ultra-High Pressure Tubing
60

High Pressure Tubing - Accessories
62

High Pressure Fittings
63

Check Valve Assemblies
69

Inline Water Filters
70

HP Water Filter Assemblies
71

Swivel Joints
72

Swivel Joints - Cap Assemblies
72

Swivel Joints - Straight Bodies
73

90 Degree Bodies
74

Bushings
74

Thrust Bearings
75

Seal Assemblies
75

Repair & Tool Kits
76

Coning & Threading Tool Kits
77

Threading Tool Assemblies
78

Coning & Threading
79

Miscellaneous Parts & Supplies 80

LP Water Filter Components
81

Hydraulic Oil Filter Components
81

O-Rings for Sealing Heads
82

O-Rings for Pneumatic Valves
82

O-Rings for Topworks
83

O-Rings for Cutting Heads
85

O-Rings for Inline Filters
86

Booster Pumps
86

Hoses
86

Gauges
87

Electrical Components
88

Light Bulbs
89

Pressure Transducers
89

Topworks Tools
90

Lubricants
92

The Value of PRO 90,000psi Cutting
93

Frequently Ordered Parts & Notes
94

KMT PUMPS PORTFOLIO



125 HP



60 HP



200 HP



100

PRO SERIES | 90,000 PSI

PRO SERIES | 90,000psi | LOWEST COST PER PART!

Available in 125 HP and 60 HP

The STREAMLINE PRO® Series Pumps significantly increase cutting productivity by 50 - 70% and use up to 50% less abrasive vs. industry standard 60,000 PSI/50 HP & 100 HP cutting.

SL-VI SERIES | 60,000psi | THE PROVEN INDUSTRY WORKHORSE

Available in 200 HP, 100 HP, 50 HP and 15 HP

The STREAMLINE® SL-VI Series is a configurable designed waterjet pump that can be custom built based on a variety of options to meet your cutting solution requirements.

CLASSIC SERIES | 60,000psi | RELIABLE PERFORMANCE AT A VALUE

Available in 50 HP and 30 HP

The STREAMLINE® CLASSIC Series employs long-stroke technology designed for ease of use, reliability and maximum uptime...*Classic KMT with modern technology!*

TRILINE DIRECT DRIVE | 55,000psi | ECONOMICAL & DEPENDABLE CUTTING

Available in 30 HP

The TRILINE® pump has an excellent cost of ownership value and can be used as a stand-alone unit for everyday cutting needs.

BROADEST RANGE OF WATERJET PUMPS



50 HP



50 HP & 30 HP



50 HP & 30 HP



15 HP



30 HP

STREAMLINE & CLASSIC SERIES | 60,000 PSI

**TRILINE DD
55,000 PSI**

CUT WITH PRO 90,000 PSI FOR LOWEST COST PER PART!

The KMT Cut Calculator App 2.0 compares 90,000 PSI vs. 60,000 PSI cutting and shows the lowest cost per part results for your cutting application!

MAXIMUM PERFORMANCE • MAXIMUM POWER • FASTEST CUTTING

The KMT App incorporates 25 materials, offers a wider range of substrate thicknesses, horsepower, orifice size and abrasive rates.

KMT STREAMLINE PRO®. WORLD'S FASTEST WATERJET!



KMT Cut Calculator App 2.0



INTENSIFIER REPLACEMENT PARTS

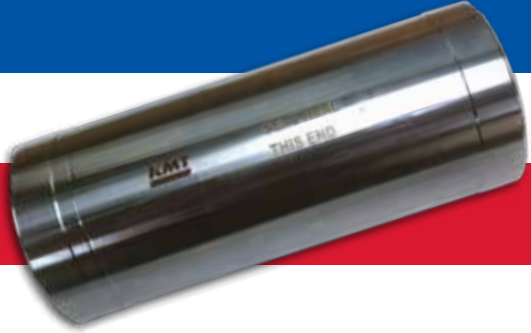

Intensifier Replacement Parts

KMT INTENSIFIER

KMT Intensifier - The Source of Pressure

No other system incorporates the features of
KMT Intensifiers to deliver the simplest,
easiest-to-operate, most reliable system.



The KMT intensifier is the heart of your waterjet system and helps determine the quality and quantity of the products you make. The use of KMT Genuine Parts to maintain your intensifier helps maximize life and improves value.

KMT STREAMLINE PRO® intensifier replacement parts are available exclusively from KMT and require precision manufacturing to ensure the best performance from your STREAMLINE PRO® pump.

KMT Intensifier Features:

- Plunger – KMT intensifiers use a longer pressurizing stroke than other manufacturers, thereby stroking less frequently for longer life.
- Seals – KMT's Hyperlife™ seals (U.S. Patent #6,769,695 and Sweden Patent #0203660-6) used in the Streamline topworks provides greater value than inferior, imitation parts.
- Metal-to-Metal Seal Head – Ensures positive sealing & the ability to re-use crucial components, saving you money.

SEAL ASSEMBLIES

DESCRIPTION

UHP Seal Assembly - SUPRAlife, Canister .88 dia. plunger

90,000psi/6,200 bar
Used on PRO-III units with a 60 or 125 horsepower rating

UHP Seal Assembly - 0.88 dia. plunger

90,000psi/6,200 bar
Used on select SL PRO-I units with 60 or 125 hp rating

HP Seal Assembly - 1.13 plunger units

60,000psi/4,100 bar
Used on all SL-V and SL-VI units with a 75 to 200 horsepower rating

HP Seal Assembly - 1.13 plunger units, hybrid

60,000psi/4,100 bar
Used in some specialty applications on SL-IV Plus, SL-V and SL-VI 75 HP - 200 HP units

HP Seal Assembly - 0.88 plunger units

55,000-60,000psi, 3,800/4,100 bar
Used on NeoLine SL-IV Plus 15hp - 60hp, SL-V 15hp - 60hp and SL-VI 15hp - 60hp units

HP Seal Assembly - 0.88 plunger units

55,000-60,000psi, 3,800/4,100 bar
Used on SL-IV Plus units with a 15 - 60 hp rating.

HP Seal Assembly - 0.88 plunger units

55,000psi/3,800 bar
Used in SL-IV units with a 15 to 50 HP rating

HP Cylinder Seal Assembly - 0.88 plunger units

55,000psi/3,800 bar
Used on some SL-III and all SL-IV units

PART No.

72158494



20479499



05149711



20467135



20422243



05149703



05123385



05027172



SEALS, SPACERS & REPAIR KITS

DESCRIPTION

PART No.

SEALS & SPACERS

- **Sealing Head Seal**
 55,000psi/3,800 bar.
 Used on SL-IV units
- **Sealing Head Spacer, 1.13 plunger units**
 60,000psi/4,100 bar
 Used on all SL-V units with a 75 to 200 horsepower rating
- **Sealing Head Spacer**
 60,000psi/4,100 bar
 Used on SL-IV Plus units with a 15, 30, 50 or 60 horsepower rating

10110393



05144597



05144696



REPAIR KITS

- **Repair Kit - Hydraulic Piston PRO 90,000psi**
 Kit includes retaining rings, bearings, o-rings, backup rings, seal assembly and check valves.

Repair Kit PRO-III

72168337

Repair Kit PRO-2

72168337

Repair Kit PRO-I

72168337



- **Repair Kit - Hydraulic Piston, 1.13 plunger units.**

55,000-60,000psi, 3,800-4,100 bar. Used on all SL-V and SL-VI units with a 75 to 200 horsepower rating. Kit includes retaining rings, bearings, o-rings, backup rings, seal assembly and check valves.

80085079



REPAIR KITS

DESCRIPTION

Repair Kit - Hydraulic Piston, 0.88 plunger units.

55,000-60,000psi, 3.800-4.100 bar. Used on all SL-V and SL-VI units with a 15 to 60 horsepower rating. Kit includes retaining rings, bearings, o-rings, backup rings, seal assembly and check valves

Repair Kit - HP Cylinder Assembly

Used on SL-IV, 55,000psi/3,800 bar. Kit includes seals, o-rings and backup rings to repair the HP cylinder seal and the sealing head seal.

PROXIMITY SWITCH KITS

Proximity Switch Kit SL-VI

55,000-60,000psi, 3.800-4.100 bar
Used on all SL-VI units with a 15 to 50 horsepower rating

Proximity Switch Kit - E50

55,000-60,000psi, 3.800-4.100 bar
Used on all SL-IV, SL-V, Classic and OEM units with a 15 to 60 horsepower rating
Replaces Part #05127584

Proximity Switch Kit SL-VI

Used on all SL-VI 60,000psi/4.100 bar units with a 100-200 horsepower rating

Used on all 90,000psi/6.200 bar PRO units

Proximity Switch Kit

Used on all SL-IV and SL-V 60,000psi/4.100 bar units with a 75-200 horsepower rating

Used on 90,000psi/6.200 bar PRO-1 and PRO-2 units

PART No.

05115951



05115977



72146433



20453934



72141569



20453925



HYDRAULIC CYLINDERS & HEADS

DESCRIPTION

PART No.

Hydraulic Cylinder, 0.88 plunger HSEC units
 55,000-60,000psi, 3.800-4.100 bar
 Used on all SL-IV, SL-V, Classic and OEM units with a 15 to 60 horsepower rating

05034764



Hydraulic Cylinder, 1.13 plunger HSEC units
 55,000-60,000psi, 3.800-4.100 bar
 Used on all SL-V units with a 75 to 200 horsepower rating and PRO units with a horsepower rating of 60 or 125. Replaces 05144514.

7219007434



Hydraulic Cylinder Head, 0.88 plunger, HSEC units
 55,000psi/3.800 bar
 Used on all Classic units with a 30 or 50 horsepower rating

20414880



Hydraulic Cylinder Head, 0.88 plunger, HSEC units
 60,000psi/4.100 bar
 Used on all SL-IV, SL-V and OEM units with a 15 to 60 horsepower rating

05034772



Hydraulic Cylinder Head, 1.13 plunger, HSEC units
 60,000psi/4.100 bar
 Used on all SL-V units with a 75 to 200 horsepower rating

20416445



PUMP PLUNGERS

DESCRIPTION	PART No.	
<p> Ceramic Plunger - 0.88 plunger units 90,000psi/6.200 bar Used on all PRO-III units</p>	72162253	
<p> Ceramic Plunger - 0.88 plunger units 90,000psi/6.200 bar Used on all SL-VI PRO units</p>	72138164	
<p> Ceramic Plunger - 0.88 plunger units 60,000/90,000psi - 4.100/6.200 bar Used on all SL-V and SL-VI units with a 15 to 60 horsepower rating and on all PRO-I and PRO-2 units</p>	05119151	
<p> Ceramic Plunger - 1.13 plunger units 60,000psi/4.100 bar Used on all SL-V and SL-VI units with a 75 to 200 Horsepower rating</p>	05144506	
<p> Carbide Plunger, 0.88 plunger units 55,000psi/3.800 bar Used on all Classic and NL-I units with a 30 to 50 horsepower rating.</p>	05039771	

LINERS

DESCRIPTION

PART No.

■	<p>Liner - UHP Cylinder, 0.88 plunger units, Stainless Steel 90,000psi/6.200 bar Used on all PRO-III with a 60 or 125 horsepower rating</p>	72163802	
■	<p>Liner - UHP Cylinder, 0.88 plunger units, Stainless Steel 90,000psi/6.200 bar Used on all PRO-2 with a 60 or 125 horsepower rating</p>	72127441	
■	<p>Liner - UHP Cylinder, 0.88 plunger units 90,000psi/6.200 bar Used on all PRO-1 and PRO-2 units with a 60 or 125 horsepower rating</p>	20474333	
■	<p>Liner - HP Cylinder, 1.13 plunger units 60,000psi/4.100 bar Used on all SL-V and SL-VI units with a 75 to 200 Horsepower rating</p>	72110945	
■	<p>Liner - HP Cylinder 0.88 plunger units 60,000psi/4.100 bar</p>	20497767	
■	<p>Liner - HP Cylinder, 0.88 plunger units, Brass 60,000psi/4.100 bar</p>	20491603	

BACKUP RINGS

DESCRIPTION



Hydraulic Piston Assembly Backup Ring

60,000/90,000psi - 4.100/6.200 bar
Used on SL-IV, SL-V & OEM 7/8" plunger units with a 15 to 60 horsepower rating and PRO units with a horsepower rating of 60 or 125



5.25 x 5.50, 1.13 plunger units - Backup Ring

60,000/90,000psi - 4.100/6.200 bar
Used on all SL-V and SL-VI (PRO) units with a 75 to 200 horsepower rating



3.75 x 4.0, 0.88 plunger units - Backup Ring

55,000-60,000psi, 3.800-4.100 bar
Used on all SL-IV, SL-V and SL-VI units with a 15 to 60 horsepower rating.

PART No.

05049994



05120092



05034855



HYDRAULIC CARTRIDGE SEAL ASSEMBLIES



0.88 plunger units

60,000/90,000psi - 4.100/6.200 bar
Used on all SL-IV, SL-V and SL-VI units with a 15 to 60 horsepower rating and all PRO units with a 60 or 125 horsepower rating



1.13 plunger units

60,000psi/4.100 bar
Used on all SL-V and SL-VI units with a 75 to 200 horsepower rating



0.88 plunger units

55,000psi/3.800 bar
Used on all Classic units with a 30 or 50 horsepower rating & NEOLINE 40 units

05130091



05146584



80086622



HYDRAULIC PISTON ASSEMBLIES

DESCRIPTION

1.13 plunger units

55,000-60,000psi, 3.800-4.100 bar
 Used on all SL-V units with a 75 to 200 horsepower rating
 Kit includes piston, retaining rings, bearings, o-rings, backup rings, seal assembly and check valves

0.88 plunger units

55,000-60,000psi, 3.800-4.100 bar
 Used on all SL-IV, SL-V, Classic and OEM units with a 15 to 60 horsepower rating
 Kit includes piston, retaining rings, bearings, o-rings, backup rings, seal assembly and check valves

Seal Assembly - Hydraulic Piston, 0.88 plunger units

55,000-60,000psi, 3.800-4.100 bar
 Used on all SL-V, Classic and OEM units with a 15 to 60 horsepower rating

Bearing - Hydraulic Piston, 0.88 plunger units

55,000-60,000psi, 3.800-4.100 bar
 Used on all SL-V, Classic and OEM units with a 15 to 60 horsepower rating

PART No.

05146576



05132253



05117965



05117940



CYLINDERS

DESCRIPTION	PART No.	
<p>PRO-III Cylinder - 0.88 plunger units 90,000psi/6,200 bar Used on all PRO-III units with a 60 or 125 horsepower rating</p>	72166738	
<p>PRO-2 Cylinder - 0.88 plunger units 90,000psi/6,200 bar Used on all PRO-2 and SL-VI PRO units with a 60 or 125 horsepower rating</p>	72121858	
<p>PRO-1 Cylinder - 0.88 plunger units 90,000psi/6,200 bar Used on all PRO-1 units with a 60 or 125 horsepower rating</p>	72121850	
<p>Cylinder - 1.13 plunger HSEC-C 60,000psi/4,100 bar Used on all SL-VI units with a 100 to 200 horsepower rating</p>	72154588	
<p>Cylinder - 1.13 plunger HSEC 60,000psi/4,100 bar Used on all SL-V units with a 75 to 200 horsepower rating Replaces Part #20473479 & #20431076</p>	72119536	
<p>Cylinder - 0.88 plunger HSEC-C 60,000psi/4,100 bar Used on all SL-VI units with a 15 to 50 horsepower rating</p>	72160831	
<p>Cylinder - 0.88 plunger HSEC 60,000psi/4,100 bar Used on all SL-V and OEM units with a 15 to 60 horsepower rating Replaces Part #20479503 & #05144647</p>	72119544	

CYLINDERS

DESCRIPTION

- **0.88 plunger**
 55,000psi/3.800 bar
 Used on SL-IV SSEC and NL-I units
- **0.88 plunger HSEC units**
 55,000psi/3.800 bar
 Used on all Classic units with a 30 or 50 horsepower rating. **Replaces Part #20434777**
- **0.88 plunger HSEC units**
 55,000psi/3.800 bar
 Used on all Classic version I units with a 50 horsepower rating. **Replaces Part #20414862**

PART No.

05059712



72119529



72120023



HIGH PRESSURE CYLINDER NUTS

- **HP Cylinder Nut - HSEC (Hard Seal End Cap)
0.88 plunger**
 60,000psi/4.100 bar. Used on all SL-V and OEM units with a 15 to 60 horsepower rating
- **HP Cylinder Nut - SSEC (Soft Seal End Cap)**
 55,000psi/3.800 bar. Used on all SL-IV units
- **1.125 HP Cylinder Nut, HSEC (Hard Seal End Cap)**
 60,000psi/4.100 bar. Used on SL-IV Plus 75hp - 200hp, SL-V 75hp - 200hp, SL-VI 75hp - 200hp
- **UHP Cylinder Nut, HSEC (Hard Seal End Cap)**
 90,000psi/6.200 bar. Used on PRO 2 units

80073646



05059688

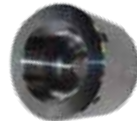

49838220



72101164



BUSHING RETAINER FLANGES

DESCRIPTION

PART No.



0.88 plunger units

55,000-60,000psi, 3.800-4.100 bar
Used on all SL-IV, SL-V, Classic & OEM units with a 15 to 60 horsepower rating

05007786



1.13 plunger units

60,000psi/4.100 bar
Used on all SL-V units with a 75 to 200 horsepower rating

05145099



RETAINING RINGS



1.011 x 0.030 x 0.118, Stainless Steel

90,000psi/6.200 bar
Used on all 90,000psi/6.200 bar units

20492123



2.75, Stainless steel

60,000psi/4.100 bar
Used on all 60,000psi/4.100 bar units

05034798



MISCELLANEOUS



Jackbolt - HSEC, 7/16-20 x 2.31

Used on all SL-V, Classic and OEM HSEC units

80070352



HP Attenuator Assembly - 0.96L

Used on all 60,000psi/4.100 bar units.

05040696









SEALING HEADS

Sealing Heads



SEALING HEAD ASSEMBLIES

DESCRIPTION	PART No.	
<p>0.88 plunger</p> <p>90,000psi/6,200 bar Used on all PRO-III units</p>	72170157	
<p>0.88 plunger</p> <p>90,000psi/6,200 bar Used on all PRO-2 and SL-VI PRO units</p>	20480087	
<p>0.88 plunger, 4 stud.</p> <p>90,000psi/6,200 bar Used on all PRO-I units</p> <p>Uses o-ring 10146082</p>	20480113	
<p>1.13 plunger units HSEC-C</p> <p>60,000psi/4,100 bar Used on all SL-VI units with a 100 to 200 horsepower rating</p>	72154603	
<p>1.13 plunger units HSEC</p> <p>60,000psi/4,100 bar Used on all SL-V units with a 75 to 200 horsepower rating</p>	72110979	
<p>0.88 plunger units HSEC-C</p> <p>55,000-60,000psi, 3,800-4,100 bar Used on all SL-VI units with a 15 to 50 horsepower rating</p>	72142526	
<p>0.88 plunger units HSEC</p> <p>55,000-60,000psi, 3,800-4,100 bar Used on all SL-V, Classic and OEM units with a 15 to 60 horsepower rating</p>	20481005	

SEALING HEAD ASSEMBLIES

DESCRIPTION

0.88 plunger units
 60,000psi/4.100 bar
 Used on SL-IV Plus flange units

0.88 plunger units
 55,000psi/3.800 bar
 Used on SL-IV units
 Uses o-ring 05049853

0.88 plunger units
 55,000psi/3.800 bar
 Used on NL-1 units

PART No.

05144688



05116769



20417081



SEALING HEADS

DESCRIPTION

0.88 plunger units

90,000psi/6,200 bar
Used on all sealing head assemblies for PRO-2 units

0.88 plunger units

90,000psi/6,200 bar
Used on all sealing head assemblies for PRO-I units

1.13 plunger units

60,000psi/4,100 bar
Used on all sealing head assemblies for SL-V units with a 75 to 200 horsepower rating

0.88 plunger units

55,000-60,000psi, 3,800-4,100 bar
Used on all sealing head assemblies for SL-V, Classic and OEM units with a 15 to 60 horsepower rating

0.88 plunger units

60,000psi/4,100 bar
Used on SL-IV Plus flange units

1.13 plunger units

55,000psi/3,800 bar
Used on SL-IV units with a 15 to 60 horsepower rating

0.88 plunger units

55,000psi/3,800 bar
Used on NL-I units

PART No.

72113373



20479524



72110961



20481009



05144357



10106417



20417000



GLANDS

GLANDS

- **UHP Sealing Head, 0.88 plunger units**

90,000psi/6.200 bar
 Used on all sealing head assemblies for PRO units
- **HP Sealing Head, 1.13 plunger units**

60,000psi/4.100 bar
 Used on all sealing head assemblies for SL-V units with a 75 to 200 horsepower rating
- **HP Sealing Head, 0.88 plunger units**

55,000-60,000psi, 3.800-4.100 bar
 Used on all sealing head assemblies for SL-IV, SL-V, Classic & OEM units with a 15 to 60 horsepower rating

PART No.

20481660



05116595



05116777



REPAIR KITS

DESCRIPTION

PART No.

UHP Check Valve PRO (Inlet/Discharge) Ball Style Inlet/discharge, 0.88 plunger units

72117819

90,000psi/6.200 bar
Used on all PRO-2 and PRO-III units that utilize an inlet ball. Kit includes seat, discharge poppet, inlet ball, poppet pin, dowel pin & compression spring



UHP Check Valve PRO-2, Discharge Kit, 0.88 plunger units

72135447

90,000psi/6.200 bar
Used on sealing head assemblies for PRO-2 units. Kit includes seat, discharge poppet, poppet pin & compression spring



UHP Check Valve (Poppet Style) Inlet Inlet/discharge, 0.88 plunger units

20477505

90,000psi/6.200 bar
Used on all sealing head assemblies for PRO-I units that utilize an inlet poppet. Kit includes valve seat, inlet and discharge poppets, poppet pin and compression spring



HP Check Valve, Discharge, 1.13 plunger units

80084403

60,000psi/4.100 bar
Used on all sealing head assemblies for SL-V units with a 75 to 200 horsepower rating. Kit includes valve seat, discharge poppet, poppet pin and compression spring



REPAIR KITS

DESCRIPTION

PART No.

HP Check Valve Discharge, 0.88 plunger units
 55,000-60,000psi, 3.800-4.100 bar
 Used on all SL-V, Classic and OEM units with a 15 to 60 horsepower rating. Kit includes valve seat, discharge poppet, poppet pin and compression spring

05133335



HP Check Valve, Inlet/Discharge, 1.13 plunger units
 60,000psi/4.100 bar
 Used on all SL-V and SL-VI units with a *button style* poppet with a 75 to 200 horsepower rating. Kit includes valve seat, inlet and discharge poppets, poppet pin and compression spring

72125203



HP Check Valve, Inlet/Discharge, 1.13 plunger units
 60,000psi/4.100 bar
 Used on all SL-V units with *washer style* inlet with a 75 to 200 horsepower rating. Kit includes valve seat, inlet and discharge poppets, poppet pin and compression spring

20427747



HP Check Valve, Inlet/Discharge, 0.88 plunger units
 55,000-60,000psi, 3.800-4.100 bar
 Used on all SL-V and SL-VI units with a *button style* poppet with a 15 to 60 horsepower rating. Kit includes valve seat, inlet and discharge poppets, poppet pin, compression spring & poppet retainer screw

20489495



HP Check Valve, Inlet/Discharge
 55,000-60,000psi, 3.800-4.100 bar
 Used on SL-IV & SL-V units with a *washer style* inlet poppet. Kit includes valve seat, inlet & discharge poppets, poppet pin & compression springs

80074057





NEO SERIES KITS



NEO 30 HP & 50 HP Part Kits

NEO SERIES KITS

DESCRIPTION
 NEO 60,000psi-4.100 bar Pumps

PART No.

	Check Valve Repair Kit - NEO 30 & 50 HP	1011158
	Hydraulic Piston Repair Kit - NEO 30 & 50 HP	1011220
	High Pressure Seal Repair Kit - NEO 30 & 50 HP	1011159
	Dump Valve Repair Kit - NEO 30 & 50 HP	05116017
	500h Maintenance Kit - NEO 30 & 50 HP	1011160
	1.000h & 2.000h Maintenance Kit - NEO 30 & 50 HP	1011161
	3.000h Maintenance Kit - NEO 30 & 50 HP	1011164
	Water Filter Element Kit - NEO 30 & 50 HP	7219013575
	Oil Filter Element - NEO 30 & 50 HP	05049689



CUTTING HEADS

AUTOLINE® PRO
ASSEMBLY



IDE® PRO
ASSEMBLY



AUTOLINE® II
ASSEMBLY



IDE® II
ASSEMBLY

Cutting Heads

CUTTING HEADS

DESCRIPTION

PART No.

IDE PRO Assembly

90,000psi/6.200 bar

Diamond Orifice

0.007" / 0.17 mm

20481407

0.008" / 0.20 mm

20481408

0.009" / 0.23 mm

20481409

0.010" / 0.25 mm

20481410

0.011" / 0.28 mm

20481411

0.012" / 0.30 mm

20481412

0.013" / 0.33 mm

20481413

0.014" / 0.35 mm

20481414

0.015" / 0.38 mm

20481415

0.016" / 0.40 mm

20481416

0.018" / 0.46 mm

20481418



AUTOLINE PRO Assembly

90,000psi/6.200 bar, 0.75 UHP
 (Orifice Assembly & Focusing Tube Not Included)

20480707



IDE II Assembly - Without Short Stop Filter Element

60,000psi/4.100 bar

Diamond Orifice

0.007" / 0.17 mm

20477959007

0.008" / 0.20 mm

20477959008

0.009" / 0.23 mm

20477959009

0.010" / 0.25 mm

20477959010

0.011" / 0.28 mm

20477959011

0.012" / 0.30 mm

20477959012

0.013" / 0.33 mm

20477959013

0.014" / 0.35 mm

20477959014

0.016" / 0.40 mm

20477959016

0.018" / 0.46 mm

20477959018



CUTTING HEAD ASSEMBLIES

DESCRIPTION

PART No.

IDE II Assembly - With Short Stop Filter Element

60,000psi/4.100 bar

Diamond Orifice & Short Stop Filter

0.007" / 0.17 mm

20477950007

0.008" / 0.20 mm

20477950008

0.009" / 0.23 mm

20477950009

0.010" / 0.25 mm

20477950010

0.011" / 0.28 mm

20477950011

0.012" / 0.30 mm

20477950012

0.013" / 0.33 mm

20477950013

0.014" / 0.35 mm

20477950014

0.016" / 0.40 mm

20477950016

0.018" / 0.46 mm

20477950018



AUTOLINE II Assembly

60,000psi/4.100 bar

0.030 wear insert, 0.38 HP

(Orifice Assembly & Focusing Tube Not Included)

20453949

0.043 wear insert, 0.38 HP

(Orifice Assembly & Focusing Tube Not Included)

20454108



AUTOLINE I Assembly

60,000psi/4.100 bar

0.030 wear insert, 0.38 HP

(Diamond & Focusing Tube Not Included)

05078530



CUTTING HEAD PARTS

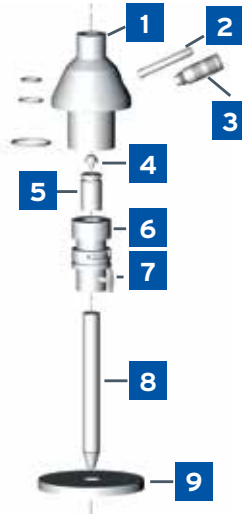

AUTOLINE Components

- 1 Cap
- 2 Abrasive Feed Liner
- 3 Handle
- 4 Diamond Orifice
- 5 LONGLIFE Mixing Chamber
- 6 Nozzle Body
- 7 Wing Screw Focusing Tube
- 8 LONGLIFE Focusing Tube
- 9 Guard

Cutting Head Parts

CAP & BODY

DESCRIPTION

AUTOLINE PRO

90,000psi/6.200 bar
0.75 UHP

For o-rings see pages 80-84

AUTOLINE II

60,000psi/4.100 bar
0.38 UHP

For o-rings see pages 80-84

AUTOLINE I

60,000psi/4.100 bar
0.38 UHP

For o-rings see pages 80-84

PART No.

20480732



20453952



05076971



Body

AUTOLINE PRO

90,000psi/6.200 bar

For o-rings see pages 80-84

AUTOLINE II

60,000psi/4.100 bar

For o-rings see pages 80-84

AUTOLINE I

60,000psi/4.100 bar

For o-rings see pages 80-84

20480715



20453958



05073820



WEAR INSERTS

DESCRIPTION

PART No.

AUTOLINE PRO

90,000psi/6.200 bar

20454861



AUTOLINE II

60,000psi/4.100 bar

0.030, 25° Inlet (For o-rings see pages 80-84)

20453064

0.043, 25° Inlet

20453082

0.054, 25° Inlet

20454339



AUTOLINE I

60,000psi/4.100 bar

0.030, 45° Inlet, Tungsten Carbide

05076955

0.043, 45° Inlet, Tungsten Carbide

05135827

0.052, 45° Inlet, Tungsten Carbide

20442434



SPARE PARTS KITS

AUTOLINE PRO

90,000psi/6.200 bar

Kit includes the setscrew and o-rings to service any AUTOLINE PRO assembly

20479589



AUTOLINE II

60,000psi/4.100 bar

Kit includes the setscrew and o-rings to service any AUTOLINE II assembly

20454129



AUTOLINE I

60,000psi/4.100 bar

Kit includes the setscrew and o-rings to service any AUTOLINE I assembly

05077367



ABRASIVE FEED TUBE ADAPTERS

DESCRIPTION



AUTOLINE PRO & AUTOLINE II,
60,000/90,000psi-4.100/6.200 bar
Stainless Steel



AUTOLINE I
Stainless Steel



IDE II & IDE PRO, 60,000/90,000psi-4.100/6.200 bar
Stainless Steel - Utilizes KMT part no. 10074870 O-ring,
sold separately on page 85.

PART No.

20453973

05076989

20454303



ABRASIVE FEED TUBE ASSEMBLY



AUTOLINE PRO & AUTOLINE II,
60,000/90,000psi-4.100/6.200 bar Includes
10142610 O-ring.

20453964



KNOB RETAINER



AUTOLINE PRO & AUTOLINE II,
60,000/90,000psi-4.100/6.200 bar,
Stainless Steel, T-Handle

20453976



AUTOLINE I
Stainless Steel

05078712



ABRASIVE GUARD



AUTOLINE PRO, AUTOLINE II & I
60,000/90,000psi-4.100/6.200 bar

05087168



90,000psi/60,000psi, KMT Cup Style

72148276



IDE RETAINING NUT

DESCRIPTION

PART No.



0.38, Stainless Steel, 60,000/90,000psi-4.100/6.200 bar

Used with IDE PRO and IDE II cutting heads

20454342

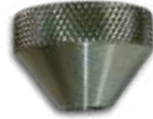

FOCUSING TUBE RETAINING COLLET



0.373 ID, Brass, 60,000/90,000psi-4.100/6.200 bar

Retaining ring for IDE PRO and IDE II cutting heads

20454345



SHORT STOP ADAPTER ASSEMBLY

Required when incorporating an IDE II cutting head into an existing system with a KMT pneumatic valve



Short Stop Filter Adapter, HP, 60,000psi/4.100 bar
 0.25 M x 0.25 F

72169858



0.38 M x 0.25 F, High Pressure Tubing
 60,000psi/4.100 bar

20454363



0.38 M x 0.38 F, High Pressure Tubing
 60,000psi/4.100 bar

20454366



Short Stop Filter Element, 60,000/90,000psi-4.100/6.200 bar

20454426



Short Stop Filter Adapter, Ultra-high Pressure Tubing, 90,000psi/6.200 bar, 0.25 M x 0.25 F

7219014304



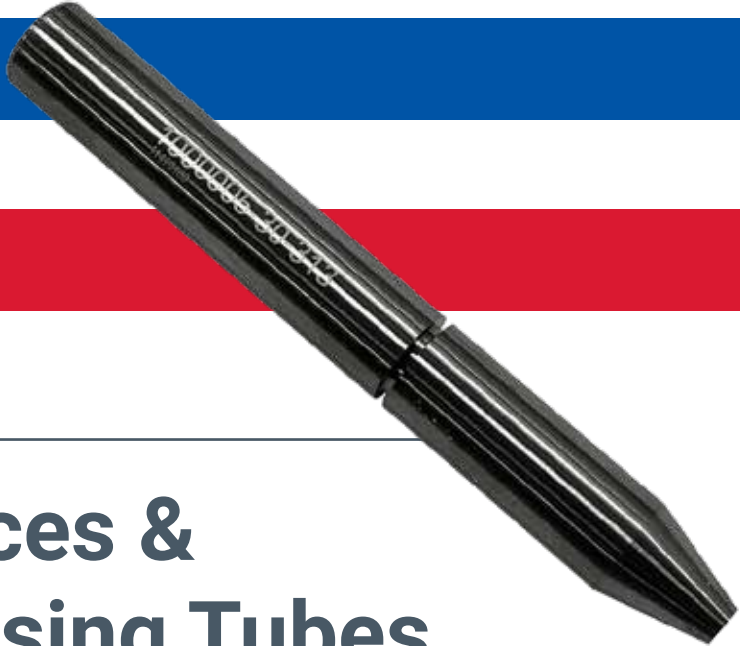

Orifices & Focusing Tubes

ABRASIVE ORIFICES/60,000PSI

DESCRIPTION

PART No.

60,000psi/4.100 bar Abrasive Cutting

Diamond Orifice, Autoline® I & II

0.004" / 0.10 mm	20448625
0.007" / 0.11 mm	05063847
0.008" / 0.20 mm	05112537
0.009" / 0.23 mm	05084504
0.010" / 0.25 mm	05077029
0.011" / 0.28 mm	05101753
0.012" / 0.30 mm	05077300
0.013" / 0.33 mm	05136098
0.014" / 0.35 mm	05077037
0.015" / 0.38 mm	80075781
0.016" / 0.40 mm	05121512
0.018" / 0.46 mm	05114905
0.019" / 0.48 mm	80086663
0.020" / 0.51 mm	05114897

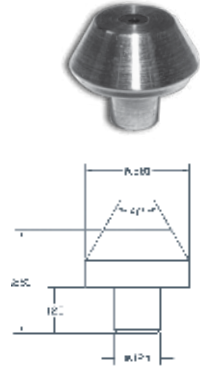

60,000psi/4.100 bar Abrasive Cutting

Sapphire Orifice, Autoline® I & II

0.007" / 0.17 mm	05109079
0.008" / 0.20 mm	05109087
0.009" / 0.23 mm	05109095
0.010" / 0.25 mm	05109103
0.011" / 0.28 mm	05109111
0.012" / 0.30 mm	05109129
0.013" / 0.33 mm	20412569
0.014" / 0.35 mm	05109137
0.016" / 0.40 mm	20448541
0.018" / 0.46 mm	05114913
0.019" / 0.48 mm	80086671
0.020" / 0.51 mm	05114921



ABRASIVE ORIFICES/90,000PSI

DESCRIPTION

PART No.

AUTOLINE PRO - ABRASVE

90,000psi/6,200 bar
For True Alignment & Maximum Performance

Wear Insert Cartridge with Diamond Orifice

0.007" / 0.17 mm	20481607
0.008" / 0.20 mm	20496208
0.009" / 0.23 mm	20481609
0.010" / 0.25 mm	20496210
0.011" / 0.28 mm	20496211
0.012" / 0.30 mm	20496212
0.013" / 0.33 mm	20481613
0.014" / 0.35 mm	20496214
0.015" / 0.38 mm	20496215



KMT Waterjet Abrasive Storage Hoppers save costs by protecting garnet and grit used for cutting hard materials like metal, stone, and composites.



WATER-ONLY ORIFICES/60,000PSI

DESCRIPTION

PART No.

Orifices For Water-Only Cutting
Standard Diamond, 60,000psi/4.100 bar

.003 (.076)	49888852
.004 (.102)	49888860
.005 (.127)	49888878
.006 (.152)	49888886
.007 (.178)	49888894
.008 (.203)	49888902
.009 (.229)	49888910
.010 (.254)	49888928
.012 (.305)	49888936
.013 (.330)	49836786
.014 (.356)	49888944
.015 (.381)	49888951
.016 (.406)	49888969
.018 (.457)	49888977
.019 (.483)	20436198
.020 (.508)	49888985
.022 (.559)	49888993

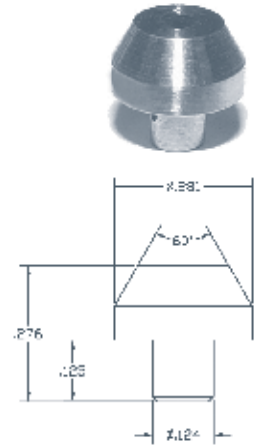

Sapphire For Water-Only Cutting
60,000psi/4.100 bar

.003 (.076)	A2260003
.004 (.102)	A2260004
.005 (.127)	A2260005
.006 (.152)	A2260006
.007 (.178)	A2260007
.008 (.203)	A2260008
.009 (.229)	A2260009
.010 (.254)	A2260010
.011 (.279)	A2260011
.012 (.305)	A2260012
.013 (.330)	A2260013
.014 (.356)	A2260014
.015 (.381)	A2260015
.016 (.406)	A2260016
.018 (.457)	A2260018
.019 (.483)	A2260019
.020 (.508)	A2260020
.022 (.559)	A2260022

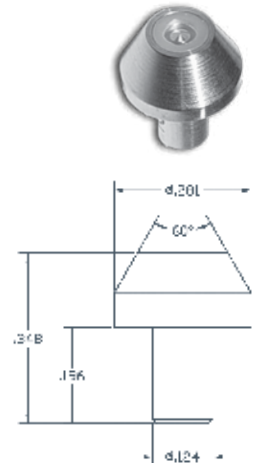

PREMIUM DIAMOND ORIFICE - FOOD & SOFT MATERIALS

DESCRIPTION

PART No.

Water-Only, 60,000psi/4.100 bar

Premium Diamond Orifice. Use for 60,000psi cutting food & soft materials like foam, rubber, and much more!

0.005" / 0.12 mm	72113688
0.006" / 0.15 mm	72132350
0.007" / 0.17 mm	72113680
0.008" / 0.20 mm	72132358
0.009" / 0.23 mm	72136231
0.010" / 0.25 mm	72136249
0.011" / 0.28 mm	72136256
0.012" / 0.30 mm	72136264

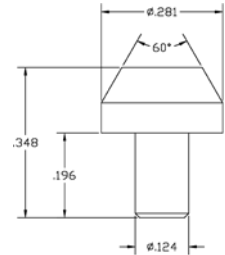

WATER-ONLY ORIFICE STREAM COMPARISONS (60,000psi)

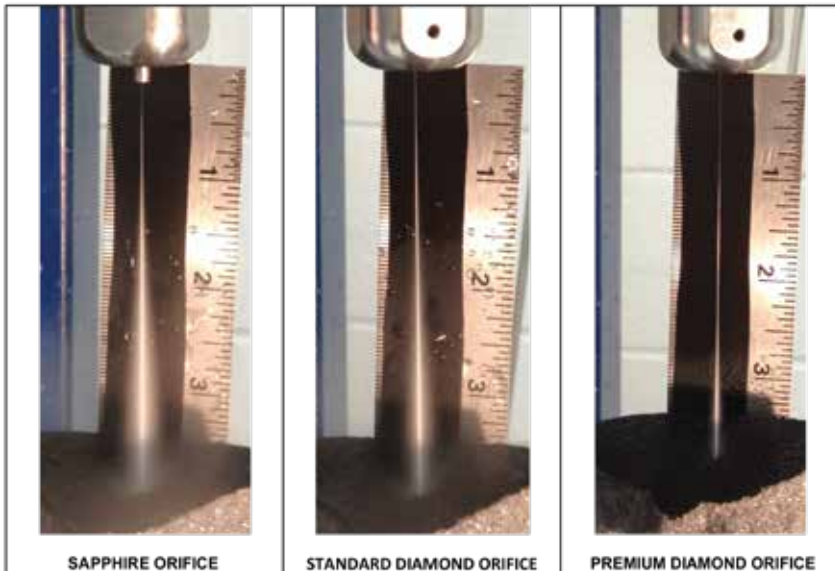

SAPPHIRE ORIFICE

STANDARD DIAMOND ORIFICE

PREMIUM DIAMOND ORIFICE

WATER-ONLY ORIFICES/90,000PSI

DESCRIPTION

Water-Only, 90,000psi/6.200 bar, Diamond

PART No.

.004 (.102)	20481704
.005 (.127)	20481705
.006 (.152)	20481706
.007 (.178)	20481707
.008 (.203)	20481708
.009 (.229)	20481709
.010 (.254)	20481710
.011 (.279)	20481711
.012 (.305)	20481712
.013 (.330)	20481713
.014 (.356)	20481714
.015 (.381)	20481715
.016 (.406)	20481716
.017 (.412)	20481717
.018 (.457)	20481718
.019 (.483)	20481719
.020 (.508)	20481720
.021 (.533)	20481721
.022 (.559)	20481722

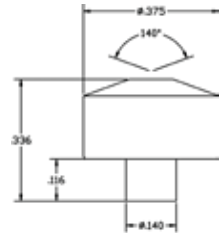

FOCUSING TUBES

DESCRIPTION

PRO Series Indexed. 90,000psi/6.200 bar

The PRO Series features the superior HYPER-TUBE Index Design for longer, more uniform wear preventing "focusing tube blow-out"

	PART No.
0.030 x 3.0 / 0.76 mm x 76 mm	20477366
0.030 x 4.0 / 0.76 mm x 102 mm	20477382
0.033 x 4.0 / 0.84 mm x 102 mm	20490760
0.040 x 3.0 / 1.02 mm x 76 mm	20486133
0.040 x 4.0 / 1.02 mm x 102 mm	20486166
0.043 x 3.0 / 1.10 mm x 76 mm	20477386
0.043 x 4.0 / 1.10 mm x 102 mm	20477395
0.045 x 3.0 / 1.14 mm x 76 mm	20486151
0.045 x 4.0 / 1.14 mm x 102 mm	20486158
0.048 x 4.0 / 1.22 mm x 102 mm	20490768

HyperTube® Index Design



ROCTEC® 100. 60,000psi/4.100 bar

0.021 x 3.13 / 0.53 mm x 79 mm	20451227
0.025 x 3.13 / 0.63 mm x 79 mm	20452309
0.030 x 3.13 / 0.76 mm x 79 mm	10126969
0.036 x 3.13 / 0.91 mm x 79 mm	80075252
0.039 x 3.13 / 0.99 mm x 79 mm	49833593
0.040 x 3.13 / 1.02 mm x 79 mm	49835390
0.043 x 3.13 / 1.10 mm x 79 mm	10126928
0.052 x 3.13 / 1.32 mm x 79 mm	05117528
0.058 x 3.13 / 1.47 mm x 79 mm	05051891
0.063 x 3.13 / 1.60 mm x 79 mm	10126936



FOCUSING TUBES

DESCRIPTION

ROCTEC® 500. 60,000psi/4.100 bar

0.021 x 2.0 / 0.53 mm x 50 mm
0.030 x 3.13 / 0.76 mm x 79 mm
0.036 x 3.13 / 0.91 mm x 79 mm
0.043 x 3.13 / 1.10 mm x 79 mm
0.093 x 3.13 / 2.36 mm x 79 mm

PART No.

05097928
05097944
05116652
05097936
05130927



Never shut down production for tank clean outs again.

The ATS 2200 and 4400 | Abrasive Removal Solution for Waterjet Cutting Systems is the perfect way to improve your waterjet operations.

SHAPE DELTA FOCUSING TUBES

DELTA STANDARD - 60,000PSI

PART No.

Delta Standard. 3.00" L, 60,000psi/4.100 bar

0.020 X 2.99 / 0.51 mm x 76 mm, 25D	1000005-20-299
0.030 X 2.99 / 0.76 mm x 76 mm, 25D	1000005-30-299
0.040 X 3.00 / 1.02 mm x 76 mm, 25D	1000005-40-300

Delta Standard. 3.125" L, 60,000psi/4.100 bar

0.015 X 3.13 / 0.38 mm x 79 mm, 25D	1000005-15-313
0.021 X 3.13 / 0.53 mm x 79 mm, 25D	1000005-21-313
0.030 X 3.13 / 0.76 mm x 79 mm, 25D	1000005-30-313
0.036 X 3.13 / 0.91 mm x 79 mm, 25D	1000005-36-313
0.039 X 3.13 / 0.99 mm x 79 mm, 25D	1000005-39-313
0.040 X 3.13 / 1.02 mm x 79 mm, 25D	1000005-40-313
0.043 X 3.13 / 1.10 mm x 79 mm, 25D	1000005-43-313



DELTA NXT PREMIUM - 60,000PSI

Delta NXT Premium. 3.00" L, 60,000psi/4.100 bar

0.020 X 2.99 / 0.51 mm x 76 mm, 25D	1000006-20-299
0.030 X 2.99 / 0.76 mm x 76 mm, 25D	1000006-30-299
0.043 X 2.99 / 1.10 mm x 76 mm, 25D	1000006-43-299

Delta NXT Premium. 3.125" L, 60,000psi/4.100 bar

0.030 X 3.13 / 0.76 mm x 79 mm, 25D	1000006-30-313
0.036 X 3.13 / 0.91 mm x 79 mm, 25D	1000006-36-313
0.040 X 3.13 / 1.02 mm x 79 mm, 25D	1000006-40-313
0.063 X 3.13 / 1.60 mm x 79 mm, 25D	1000006-63-313



SHAPE DELTA FOCUSING TUBES

DELTA PREMIUM INDEXED - 90,000PSI

PART No.

Delta Premium Indexed. 3.00" L
90,000psi/6.200 bar

0.030 X 2.99 / 0.76 mm x 76 mm, 25D	1000007-30-299
0.040 X 2.99 / 1.02 mm x 76 mm, 25D	1000007-40-299
0.043 X 2.99 / 1.10 mm x 76 mm, 25D	1000007-43-299

Delta NXT Premium Indexed. 4.00" L
90,000psi/6.200 bar

0.030 X 4.00 / 0.76 mm x 102 mm, 25D	1000007-30-400
0.040 X 4.00 / 1.02 mm x 102 mm, 25D	1000007-40-400
0.043 X 4.00 / 1.10 mm x 102 mm, 25D	1000007-43-400
0.048 X 4.00 / 1.22 mm x 102 mm, 25D	1000007-48-400



The KMT IDE® diamond cutting head cuts faster, extends focusing tube life and dramatically reduces downtime.

The IDE® cutting head has demonstrated 1,000+ cutting hours for most applications.

Pneumatic Valves (Water-Only) & Replacement Parts



PNEUMATIC VALVES / NO AND NC

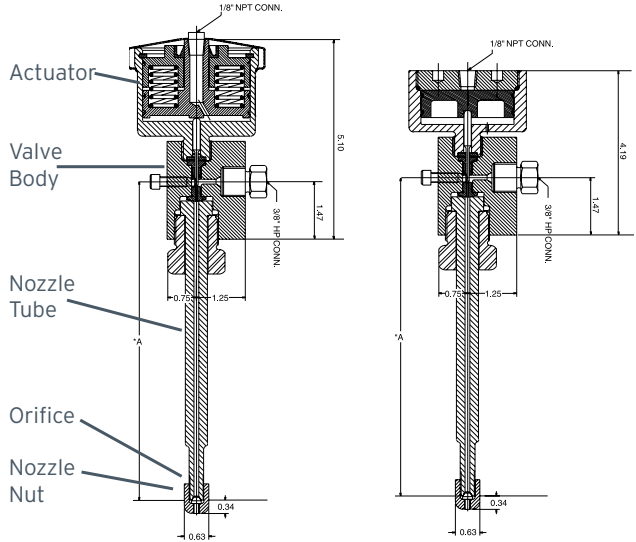





Normally Closed

Normally Open

Pure water cutting applications are among the most demanding of subcontracting jobs in the industry and the KMT AQUALINE® Water-Only valves are the industry's best!

PNEUMATIC VALVE / ACTUATOR ASSEMBLIES

DESCRIPTION	PART No.	
■ UHP, 90,000psi/6.200 bar - N/C	20480359	
■ UHP, 90,000psi/6.200 bar - N/O 2-port Dump valve	20468634	
■ HP, 60,000psi/4.100 bar - N/C	10138824	
■ HP, 60,000psi/4.100 bar - N/C, IDE® Gland	20454354	
■ HP, 60,000psi/4.100 bar - N/O	10184760	
■ HP, 60,000psi/4.100 bar - N/O 2-Port Dump valve, Solenoid valve, Square body	05069703	
■ HP, 60,000psi/4.100 bar - N/O 3-Port Dump valve, Round body	20427739	

REPAIR KITS

DESCRIPTION

PART No.

UHP Pneumatic Valve, N/C, 90,000psi/6.200 bar

20477521

Kit includes valve seat and stem, seal assembly, brass backup ring and o-rings required to service the valve and the actuator



UHP Pneumatic Valve, N/O, 90,000psi/6.200 bar

20477518

Kit includes valve seat and stem, seal assembly, brass backup ring and o-rings required to service the valve and the actuator



HP Pneumatic Valve, N/C, 60,000psi/4.100 bar

05116025

Kit includes valve seat and stem, seal assembly, backup ring & o-ring required to service the valve



HP Pneumatic Valve, N/C, Cold Weather Seal Assembly, 60,000psi/4.100 bar

05146964

Kit includes valve stem and seat, CWS seal assembly, bronze backup ring and o-ring



HP Pneumatic Valve, N/O, 60,000psi/4.100 bar

05116017

Kit includes valve seat and stem, seal assembly, backup ring & o-rings required to service the valve and the actuator



TOOL KITS

DESCRIPTION



N/C Actuator Assembly

60,000/90,000psi - 4.100/6.200 bar
Kit includes top and bottom protector tool, and snap ring pliers to service all HP and UHP, N/C pneumatic actuator assemblies



Seal Tools, HP/UHP Pneumatic Valves

60,000/90,000psi - 4.100/6.200 bar
Used to service all HP and UHP pneumatic valves. Kit includes a seal push, positioning and installation tool

PART No.

80077795



20470475



PNEUMATIC VALVE BODIES



Stainless Steel

90,000psi/6.200 bar.
For use on all KMT UHP pneumatic valves



Dump Valve, Stainless Steel

90,000psi/6.200 bar.
For use on all KMT UHP pneumatic dump valves



2-Port, (2) 0.38, (1) 0.56, Stainless Steel

60,000psi/4.100 bar.
For use on all KMT 2-port HP pneumatic valves



3-Port, 0.38, Stainless Steel

60,000psi/4.100 bar.
For use on all KMT 3-port HP pneumatic dump valves

20475871



20468617



10189181



20427648



ACTUATORS

DESCRIPTION

- UHP Actuator - N/C**
 90,000psi/6.200 bar
- UHP Actuator - N/O**
 90,000psi/6.200 bar
- HP Actuator - N/C**
 60,000psi/4.100 bar
- HP Actuator - N/O**
 60,000psi/4.100 bar
- Solenoid Valve - Air, 2 -3 Way, 2 Pos, 24V DC**
 60,000/90,000psi - 4.100/6.200 bar
- Solenoid Valve - Air, 4-Way, 2 Pos, 24 VDC**
 60,000psi/4.100 bar

PART No.

20474154

20479022

10177855

10189553

49888035

05128715



NOZZLE NUTS

DESCRIPTION

0.56, UHP
90,000psi/6.200 bar

0.75, UHP
90,000psi/6.200 bar

0.38, LH Thread
60,000psi/4.100 bar

0.56, LH Thread
60,000psi/4.100 bar

PART No.

20478993

20480993

B2841

B3393



The KMT Waterjet Cut Calculator APP (available on Google Console & Apple Store) incorporates 25 materials, offers a wider range of substrate thicknesses, horsepower, orifice size, and abrasive rates.

The calculator shows the actual time differences cutting at 90,000psi vs. 60,000psi, calculating Speed/Capacity, Cost per Part/Job, and the Abrasive Consumption/Savings.

VALVE GLANDS

DESCRIPTION



0.56, Valve nut for Nozzle Tube, Stainless Steel

60,000/90,000psi - 4.100/6.200 bar



0.75, Valve nut for Nozzle Tube, Stainless Steel

60,000/90,000psi - 4.100/6.200 bar



Compression Spring - 0.72 x 0.105 x 1.50, Stainless Steel

60,000/90,000psi - 4.100/6.200 bar

For use on all NC KMT HP/UHP pneumatic actuators



Adapter, UHP Dump Valve - 90,000psi/6.200 bar



Adapter, HP Water Valve

60,000psi/4.100 bar

For use on all HP 3-port & quick release dump valves



Adapter, Tube/Pipe, 0.25 x 0.13 60,000psi/4.100bar

Used to connect air tube to solenoid valve on pneumatic valve/actuator assemblies. Replaces part 10077030



Coupling Pipe, 0.13 x 0.13 60,000psi/4.100 bar

Used to connect solenoid valve to actuator on pneumatic valve/actuator assemblies

PART No.

BV701184



20454351

05054119



20451557



49830904



72149291



10102226



NOZZLE TUBES

DESCRIPTION

(ALL DIMENSIONS ARE DIAMETER" x LENGTH")

3/4", 90,000psi/6.200 bar, Valve Connection - IDE Connection (for use with Short Stop Filter)

	PART No.
0.75 x 3.50 / 1.9 x 8.89 cm, LH Thread	20487241
0.75 x 4.50 / 1.9 x 11.43 cm, LH Thread	20487249
0.75 x 5.75 / 1.9 x 14.60 cm, LH Thread	20487257
0.75 x 6.25 / 1.9 x 15.88 cm, LH Thread	20497106
0.75 x 9.75 / 1.9 x 24.77 cm, LH Thread	20487273



3/8", 60,000psi/4.100 bar, HP Connection - Nozzle Nut Connection (Extended Life)

0.38 x 2.56 / 0.97 x 6.50 cm	7219014145025
0.38 x 3.00 / 0.97 x 7.62 cm	7219014145030
0.38 x 4.00 / 0.97 x 10.16 cm	7219014145040
0.38 x 8.00 / 0.97 x 20.32 cm	7219014145080
0.38 x 9.00 / 0.97 x 22.86 cm	7219014145090
0.38 x 10.0 / 0.97 x 25.4 cm	7219014145100
0.38 x 11.0 / 0.97 x 27.94 cm	7219014145110
0.38 x 12.0 / 0.97 x 30.48 cm	7219014145120



NOZZLE TUBES

DESCRIPTION

(ALL DIMENSIONS ARE DIAMETER" x LENGTH")

PART No.

3/8", 60,000psi/4.100 bar, Valve Connection - HP Connection

0.38 x 4.0 / 0.97 x 10.16 cm	10138584
0.38 x 5.0 / 0.97 x 12.70 cm	10138592
0.38 x 6.0 / 0.97 x 15.24 cm	10138600
0.38 x 7.0 / 0.97 x 17.78 cm	10138618
0.38 x 8.0 / 0.97 x 20.32 cm	10138634
0.38 x 9.0 / 0.97 x 22.86 cm	10138642
0.38 x 10.0 / 0.97 x 25.40 cm	10138659



3/8", 60,000psi/4.100 bar, Valve Connection - Nozzle Nut Connection

0.38 x 3.0 / 0.97 x 10.16 cm	10181113
0.38 x 4.0 / 0.97 x 10.16 cm	10138402
0.38 x 5.0 / 0.97 x 12.70 cm	10138410
0.38 x 6.0 / 0.97 x 15.24 cm	10138428
0.38 x 7.0 / 0.97 x 17.78 cm	10138436
0.38 x 8.0 / 0.97 x 20.32 cm	10138444
0.38 x 9.0 / 0.97 x 22.86 cm	10138451
0.38 x 10.0 / 0.97 x 25.40 cm	10138469
0.38 x 11.0 / 0.97 x 27.94 cm	05136031
0.38 x 12.0 / 0.97 x 30.48 cm	05013735



3/8", 60,000psi/4.100 bar, HP Connection - Nozzle Nut Connection

0.38 x 3.0 / 0.97 x 7.62 cm	A22593
0.38 x 4.0 / 0.97 x 10.16 cm	A22594
0.38 x 5.0 / 0.97 x 12.70 cm	A22595
0.38 x 6.0 / 0.97 x 15.24 cm	A22596
0.38 x 8.0 / 0.97 x 20.32 cm	A2259800
0.38 x 10.0 / 0.97 x 25.40 cm	A225910
0.38 x 11.0 / 0.97 x 27.94 cm	A225911
0.38 x 12.0 / 0.97 x 30.48 cm	A225912



NOZZLE TUBES

DESCRIPTION

(ALL DIMENSIONS ARE DIAMETER" x LENGTH")

PART No.

9/16", 60,000psi/4.100 bar, Valve Connection - HP Connection

0.56 x 4.0 / 1.42 x 10.16 cm

10138667

0.56 x 5.0 / 1.42 x 12.70 cm

10138675

0.56 x 6.0 / 1.42 x 15.24 cm

10138683

0.56 x 7.0 / 1.42 x 17.78 cm

10138691

0.56 x 8.0 / 1.42 x 20.32 cm

10138709

0.56 x 9.0 / 1.42 x 22.86 cm

10138717

0.56 x 10.0 / 1.42 x 25.40 cm

10138725

0.56 x 11.0 / 1.42 x 27.94 cm

80074446



9/16", 60,000psi/4.100 bar, Valve Connection - Nozzle Nut Connection

0.56 x 4.0 / 1.42 x 10.16 cm

10138485

0.56 x 5.0 / 1.42 x 12.70 cm

10138493

0.56 x 6.0 / 1.42 x 15.24 cm

10138501

0.56 x 7.0 / 1.42 x 17.78 cm

10138519

0.56 x 8.0 / 1.42 x 20.32 cm

10138527

0.56 x 9.0 / 1.42 x 22.86 cm

10138535

0.56 x 10.0 / 1.42 x 25.40 cm

10181105

0.56 x 12.0 / 1.42 x 30.48 cm

10193100



3/4", 60,000psi/4.100 bar, Valve Connection - IDE Connection

0.75 x 3.75 / 1.91 x 9.53 cm, LH Thread

20489074

0.75 x 4.75 / 1.91 x 12.07 cm, LH Thread

20489092

0.75 x 5.75 / 1.91 x 14.60 cm, LH Thread

20455329

0.75 x 7.75 / 1.91 x 19.69 cm, LH Thread

20480977

0.75 x 8.75 / 1.91 x 22.23 cm, LH Thread

72101354

0.75 x 9.75 / 1.91 x 24.77 cm, LH Thread

20464647



HIGH PRESSURE FITTINGS & TUBING

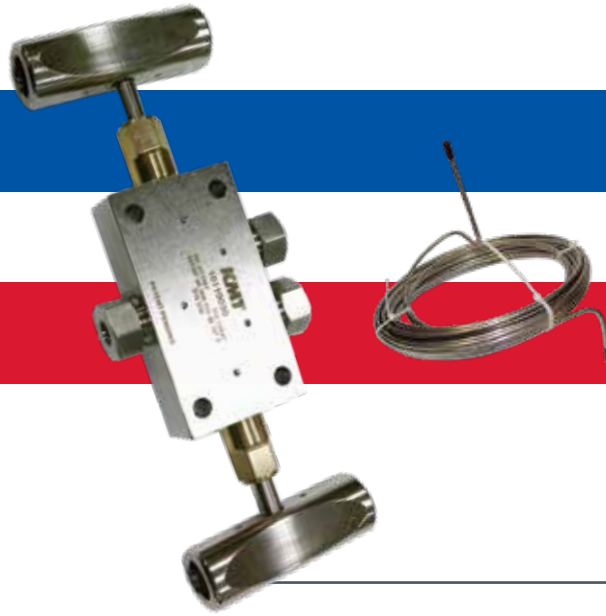

High Pressure Fittings & Tubing

ULTRA-HIGH PRESSURE TUBING

DESCRIPTION

PART No.

Stainless Steel Tubing - 90,000psi/6.200 bar Coned & Threaded - Up to 4' Lengths

0.25 x 0.083 x 3.02", HP160	20489761
0.25 x 0.083 x 4.0", HP160	20487975
0.25 x 0.083 x 7.625", HP160	72104402
0.38 x 0.125 x 4.0", HP160	20478649
0.38 x 0.125 x 4.81", HP160	20468830
0.38 x 0.125 x 48.0", HP160	20489107
0.56 x 0.188 x 4.25", HP160	20493999
0.56 x 0.188 x 6.38", HP160	72103733
0.56 x 0.188 x 8.93", HP160	72103386
0.56 x 0.188 x 14.49", HP160	72103361
0.56 x 0.188 x 17.22", HP160	72103379
0.56 x 0.188 x 36.0", HP160	72108319

Coned & Threaded - 20' Length, 90,000psi/6.200 bar

0.25 x 0.083 x 240.0", HP160	20478751
0.38 x 0.083 x 240.0", HP160	20489115
0.56 x 0.083 x 240.0", HP160	72103535

Ultra-high Pressure Tubes sold by the inch 90,000psi/6.200 bar

0.25	20455383
0.38	20455386
0.56	20455389



HIGH PRESSURE TUBING

DESCRIPTION

PART No.

Stainless Steel Tubing - 60,000psi/4.100 bar
Coned & Threaded - Up to 8' Lengths

0.25 x 0.083 x 4.0", 316	10105880
0.25 x 0.083 x 6.0", 316	10103018
0.25 x 0.083 x 8.0", 316	80070519
0.38 x 0.125 x 3.0", 316	10094704
0.38 x 0.125 x 4.0", 316	10105443
0.38 x 0.125 x 5.0", 316	10090280
0.56 x 0.188 x 4.0", 316	10069326
0.56 x 0.188 x 4.97", 316	05112057
Coned & Threaded - 20' Length	
60,000psi/4.100 bar	
0.25 x 0.083 x 240.0", 316	10094191
0.38 x 0.083 x 240.0", 316	10094183
0.56 x 0.083 x 240.0", 316	10094175
HP Tubes. Sold by the inch	
60,000psi/4.100 bar	
0.25	10064376
0.38	10064665
0.56	10061190



HP TUBING - ACCESSORIES

DESCRIPTION

PART No.



Hose - Ferrule - 60,000psi/4.100 bar

0.25 x 0.265 x 0.718, Brass

20422970

0.38 x 0.265 x 0.718, Brass

10083897

0.56 x 0.265 x 0.718, Brass

05131347



Conduit - Extra Flexible - 60,000psi/4.100 bar Sold by the inch

0.25, Stainless steel

20422988

0.38, Stainless steel

10186153

0.56, Stainless steel

05086905



HP & UHP stainless steel bent tubing is intensifier model specific. Please contact your local KMT representative for ordering assistance. 60,000/90,000psi-4.100/6.200 bar



HP & UHP stainless steel coils are robot specific. Please contact your local KMT representative for ordering assistance. 60,000/90,000psi-4.100/6.200 bar



HP FITTINGS

DESCRIPTION

PART No.

**UHP Stainless Steel Coupling Assembly,
 90,000psi/6.200 bar**

0.25 x 0.25

20477023

0.38 x 0.25

20477738

0.38 x 0.38

20477660

0.56 x 0.25

20477730

0.56 x 0.38

20477709

0.56 x 0.56

20477685



**HP Stainless Steel Coupling Assembly,
 60,000psi/4.100 bar**

0.25 x 0.25

10079028

0.38 x 0.25

10079614

0.38 x 0.38

10078905

0.56 x 0.25

10078145

0.56 x 0.38

10079531

0.56 x 0.56

10078640



**UHP Stainless Steel Elbow Assembly,
 90,000psi/6.200 bar**

0.25

20455821

0.38

20455809

0.56

20455377



**HP Stainless Steel Elbow Assembly,
 60,000psi/4.100 bar**

0.25

10079051

0.38

10078780

0.56

10078525



HP FITTINGS

DESCRIPTION	PART No.
UHP Stainless Steel Tee Assembly, 90,000psi/6.200 bar 0.25 0.38 0.56	20455824
	20455812
	20455374
HP Stainless Steel Tee Assembly, 60,000psi/4.100 bar 0.25 0.38 0.56	10079481
	10078590
	10079465
UHP Stainless Steel Cross Assembly, 90,000psi/6.200 bar 0.25 0.38 0.56	20452971
	20452968
	20453115
HP Stainless Steel Cross Assembly, 60,000psi/4.100 bar 0.25 0.38 0.56	10097228
	10078038
	10079168



HP FITTINGS

DESCRIPTION

PART No.

**UHP Stainless Steel Bushing Assembly,
 90,000psi/6.200 bar**

0.38 F x 0.25 M	72133175
0.38 M x 0.25 F	72133224
0.56 F x 0.25 M	72133183
0.56 M x 0.25 F	72133232
0.56 F x 0.38 M	72133209
0.56 M x 0.38 F	72133250

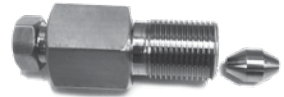

**HP Stainless Steel Bushing Assembly,
 60,000psi/4.100 bar**

0.38 M x 0.25 F	10079432
0.38 F x 0.25 M	10079473
0.56 M x 0.25 F	10079580
0.56 F x 0.25 M	10079424
0.56 M x 0.38 F	10079457
0.56 F x 0.38 M	10079655



**UHP Stainless Steel Collar
 90,000psi/6.200 bar**

0.25	20452959
0.38	20452965
0.56	20453124



**HP Stainless Steel Collar
 60,000psi/4.100 bar**

0.25	10078426
0.38	10078715
0.56	10079119



HP FITTINGS

DESCRIPTION	PART No.
UHP Stainless Steel Gland 90,000psi/6.200 bar 0.25 0.38 0.56	20452962
	20452956
	20453121
HP Stainless Steel Gland 60,000psi/4.100 bar 0.25 Anti-Vibration, 0.25 0.38 Anti-Vibration, 0.38 0.56 Anti-Vibration, 0.56	10078459
	10078699
	10078129
	10078913
	10078608
	10093573
UHP Stainless Steel Adapter Cone, 90,000psi/6.200 bar 0.25 0.38 0.56	72133266
	72122072
	72133349
HP Stainless Steel Adapter Cone, 60,000psi/4.100 bar 0.25 0.38 0.56	10116333
	10078509
	10079291



HP FITTINGS

DESCRIPTION

PART No.

**UHP Stainless Steel Plug,
 90,000psi/6.200 bar**

0.25

20453130

0.38

20453136

0.56

20453127



**HP Stainless Steel Plug,
 60,000psi/4.100 bar**

0.25

10078244

0.38

10079523

0.56

10078772



**UHP Stainless Steel Hand Valve, Straight,
 90,000psi/6.200 bar**

0.25

20467981

0.38

20468568

0.56

20468014



**HP Stainless Steel Hand Valve, Straight,
 60,000psi/4.100 bar**

0.25

10079259

0.38

10078863

0.56

10078889



HP FITTINGS

DESCRIPTION

PART No.

■ UHP Stainless Steel Hand Valve, 90 degree,
90,000psi/6.200 bar

0.25

20468610

0.38

20468593

0.56

20477836



■ HP Stainless Steel Hand Valve, 90 degree,
60,000psi/4.100 bar

0.25

10079002

0.38

10078749

0.56

10079275



■ HP Stainless Steel Valve Assembly, 3-Way,
1 Press, 0.38, 2 Stem
60,000psi/4.100 bar

10119030



CHECK VALVE ASSEMBLIES

DESCRIPTION	PART No.
Poppet Check Valve PRO Assembly 90,000psi/6.200 bar	
0.38	20477619
0.56	20455911
Repair Kit	72135447
Poppet Check Valve Assembly 60,000psi/4.100 bar	
0.25	80073885
0.38	05149182
0.56	05113972



Cutting Heads



Diamond Drifts



Fittings & Tubing



Valve Repair Kits

KMT Genuine Parts are manufactured in the USA to the exact standards as the original parts found on new KMT pumps. The use of inferior imitation parts will void warranty coverage, compromises safety and may result in reduced component lifetime.

BEWARE of websites that use the KMT logo to imply their parts are manufactured by KMT, but are not KMT Genuine Parts.

INLINE WATER FILTERS

DESCRIPTION

Filter Element UHP Water Filter Assembly

90,000psi/6.200 bar
Sintered Cup, 20 Micron.
For use with UHP Filter Assembly 20475916 &
20475944

Filter Element UHP Water Filter Assembly

90,000psi/6.200 bar
Sintered Cup, 20 Micron.
For use with UHP Filter Assembly 20481026 &
20480940

Filter Element - HP Water Filter Assembly

60,000psi/4.100 bar
0.25, Sintered Cup, 20 Micron.
For use with HP Filter Assembly 05114137

Filter Element - HP Water Filter Assembly

60,000psi/4.100 bar
.38, Sintered Cup, 20 Micron.
For use with HP Filter Assembly 49863715

Filter Element - HP Water Filter Assembly

60,000psi/4.100 bar
0.56, Sintered Cup, 20 Micron.
For use with HP Filter Assembly BF103473
Utilizes 10074599 o-ring, sold separately.

PART No.

20453553



20456913



05110531



SKJA266



AF503473



HP WATER FILTER ASSEMBLIES

DESCRIPTION

PART No.

UHP Water Filter Assembly - Inline

90,000psi/6.200 bar
 Small

0.25, Stainless Steel

20481026

0.38, Stainless Steel

20480940



UHP Water Filter Assembly - Inline

90,000psi/6.200 bar
 Large

0.38, Stainless Steel

20475916

0.56, Stainless Steel

20475944



HP Water Filter Assembly - Inline

60,000psi/4.100 bar
 0.25, 20 Micron, Stainless Steel

05114137



HP Water Filter Assembly - Inline

60,000psi/4.100 bar
 0.38, 20 Micron, Stainless Steel

CJ200988



HP Water Filter Assembly - Inline

60,000psi/4.100 bar
 0.56, 20 Micron, Stainless Steel

BF103473



Bayonet Nipple - HP Water Filter

60,000psi/4.100 bar
 0.38 - For use in HP Filter Assembly 49863715

SKJA287



SWIVEL JOINTS

DESCRIPTION	PART No.	
<p>UHP, Straight, 0.25, F/F Connections 90,000psi/6.200 bar</p>	20477623	
<p>UHP, Straight, 0.25 F/M Connections 90,000psi/6.200 bar</p>	20490851	
<p>UHP, 90°, 0.25 F/M Connections 90,000psi/6.200 bar</p>	72108129	
<p>UHP, 90°, 0.25 F/F Connections 90,000psi/6.200 bar</p>	20491098	
<p>HP, 90°, 0.25 F/F Connections 60,000psi/4.100 bar</p>	CJ218188	
<p>HP, 90°, 0.25 M/F Connections 60,000psi/4.100 bar</p>	CJ201288	
<p>HP, 90°, 0.38 M/F Connections 60,000psi/4.100 bar</p>	10134682	

SWIVEL JOINTS - CAP ASSEMBLIES

<p>Cap Assembly, 0.25/0.38, M/F 60,000psi/4.100 bar</p>	BJ701288	
<p>Cap Assembly, 0.25, F/F 60,000psi/4.100 bar</p>	CJ418088	

SWIVEL JOINTS - STRAIGHT BODIES

DESCRIPTION

- **UHP Body - Straight, 0.25 Connections**
90,000psi/6.200 bar
- **HP Body - Straight, 0.25 Connections**
60,000psi/4.100 bar
- **HP Body - Straight, 0.38 Connections**
60,000psi/4.100 bar

PART No.

- 20486976
- CJ211388
- 10134716*



SWIVEL JOINTS - STRAIGHTS

- **UHP Spindle - 0.25 F**
90,000psi/6.200 bar
- **UHP Spindle - 0.25 M**
90,000psi/6.200 bar
- **HP Spindle - 0.25 F**
60,000psi/4.100 bar
- **HP Spindle - 0.25 M**
60,000psi/4.100 bar
- **HP Spindle - 0.38 M**
60,000psi/4.100 bar

- 20486952
- 20490843
- CJ318088
- CJ201288
- 49899602



SWIVEL JOINTS - STRAIGHTS

DESCRIPTION

- **UHP, Straight, 0.25 F/F Connections**
90,000psi/6.200 bar
- **UHP, Straight, 0.25 F/M Connections**
90,000psi/6.200 bar
- **HP, Straight, 0.25 F/F Connections**
60,000psi/4.100 bar
- **HP, Straight, 0.25 M/F Connections**
60,000psi/4.100 bar
- **HP, Straight, 0.38 M/F Connections**
60,000psi/4.100 bar

PART No.

- 20477623
- 20490851
- CJ218088
- CJ211388
- 10134708



90 DEGREE BODIES

DESCRIPTION

- **UHP Body - 90°, 0.25 Connections**
90,000psi/6.200 bar
- **HP Body - 90°, 0.56 x 0.25 M/F Connections**
60,000psi/4.100 bar
- **HP Body - 90° 0.38 x 0.38 M/F Connections**
60,000psi/4.100 bar

PART No.

- 20490859
- DJ301288
- 10134690



BUSHINGS

- **Bushing, 0.25/0.38 Connection**
60,000psi/4.100 bar

CJ401288



SEAL ASSEMBLIES

DESCRIPTION



Thrust Bearing , 0.25 Connections
 90,000psi/6.200 bar



Thrust Bearing 0.25/0.38 Connection
 60,000psi/4.100 bar

PART No.

20475956

10084713



SEAL ASSEMBLIES

DESCRIPTION



Seal Assembly, 0.25 Connections
 90,000psi/6.200 bar



Seal Assembly, 0.25/0.38 Connection
 60,000psi/4.100 bar



Clamp Collar, 0.25, F/F Connection
 60,000psi/4.100 bar



Thrust Washer, 0.25/0.38 Connections
 60,000psi/4.100 bar

PART No.

20487002

BJ201388

10154680

10094647



REPAIR & TOOL KITS

DESCRIPTION

Repair Kit - UHP Swivel Joint Assembly, 0.25/0.38 Connections

90,000psi/6.200 bar

Kit includes seal assembly, thrust bearing and washer, and setscrew required to service all UHP swivel joint assemblies

Tool Kit - UHP Swivel Joint Assembly

90,000psi/6.200 bar

Kit includes maintenance tools and lubricants required to repair any UHP swivel joint assembly

Repair Kit - HP Swivel Joint Assembly, 0.25/0.38 Connections

60,000psi/4.100 bar

Kit includes seal assembly, thrust bearing and washer, and setscrew required to service all HP swivel joint assemblies

PART No.

72129713



20488720



05116009



CONING & THREADING TOOL KITS

DESCRIPTION



Tool Kit - Hand Threading & Power Coning Tools

60,000/90,000psi-4.100/6.200 bar

Kit includes 0.25, 0.38 and 0.56 power coning & hand threading tool

PART No.

20454198



Tool Kit - Power Coning/Threading Tools

60,000/90,000psi-4.100/6.200 bar

Kit includes 0.25, 0.38 and 0.56 power coning & power threading tool

20454201



The KMT Waterjet Genuine Service team offers 360° Assured Preventive Programs to keep your KMT pump operating at peak performance so you can focus on your business.



THREADING TOOL ASSEMBLIES

DESCRIPTION

Tool Assemblies include 4 oz. Coning Lubricant

PART No.

	Hand Threading Tool Assemblies, 60,000/90,000psi-4.100/6.200 bar	
	0.25	05108865
	0.38	05108873
	0.56	05108881
	Power Threading Tool Assemblies, 60,000/90,000psi-4.100/6.200 bar	
	0.25	05122742
	0.38	05120258



CONING & THREADING

	Blade, 60,000/90,000psi-4.100/6.200 bar	
	0.25, Hand or Power, Coning	05108808
	0.38, Hand or Power, Coning	05108824
	0.56, Hand or Power, Coning	05108816
	Retainer, 60,000/90,000psi-4.100/6.200 bar	
	0.25, Hand or Power, Bronze, Threading	05108741
	0.38, Hand or Power, Bronze, Threading	05108758
	0.56, Hand or Power, Bronze, Threading	05108766
	Retainer, 60,000/90,000psi-4.100/6.200 bar	
	0.25, Power, Bronze, Coning	05109814
	0.38, Power, Bronze, Coning	05109822
	0.56, Power, Bronze, Coning	05109830
	Tube Vise, 60,000/90,000psi-4.100/6.200 bar	
	0.25	05108782
	0.38	05108790
	0.56	05108774



CONING & THREADING

DESCRIPTION

PART No.

	Threading Die, 60,000/90,000psi-4.100/6.200 bar 1/4-28 LH, 0.25, Hand or Power	05108899
	3/8-24 LH, 0.38, Hand or Power	05108915
	9/16-18 LH, 0.56, Hand or Power	10078301
	Collet, 60,000/90,000psi-4.100/6.200 bar 0.25, Hand Coning, Stainless Steel	05108972
	0.38, Hand Coning, Stainless Steel	05108964
	0.56, Hand Coning, Stainless Steel	20439964



Over 50% of the waterjet operating cost is purchasing abrasive garnet.

Powering up to 90,000psi will lower your abrasive usage by 50%, increase your cutting efficiency by over 50%, and reduce electrical and waterjet costs too.





Miscellaneous Parts & Supplies



LP WATER FILTER COMPONENTS

DESCRIPTION

PART No.

■	Filter Element, LP Water, 10.0 long, polypropylene	10106722	
	60,000psi/4.100 bar		
	10 micron		
	40 micron	10100782	
■ ■	Filter Element, LP Water 10 micron, 20.0 long, polypropylene, 60,000/90,000psi-4.100/6.200 bar	72125264	
	Used on all SL-VI (PRO) units		
■ ■	Filter Element, LP Water 10 micron, 20.0 long, polypropylene, 60,000/90,000psi-4.100/6.200 bar	49834716	
	Used on all SL-V, PRO-I and PRO-2 units		
■ ■	Filter Housing Assembly, LP Water 0.75 FNPT connection, stainless steel, manual relief valve, 60,000/90,000psi-4.100/6.200 bar	72155272	
	Uses Part Number 72125264 Filter Element		
■ ■	Filter Housing Assembly - LP Water, 0.75 FNPT connections, stainless steel, manual relief valve, 60,000/90,000psi-4.100/6.200 bar	72118339	
	Uses Part Number 49834716 Filter Element Replaces Part #05038690		
■ ■	Filter Strainer, 50 NPTF, 40 Mesh, polypropylene 60,000/90,000psi-4.100/6.200 bar	20412815	

HYDRAULIC OIL FILTER COMPONENTS

■ ■	Hydraulic, 6 micron, 4.0 long, spin on, 60,000/90,000psi-4.100/6.200 bar	05049689	
	For 15 to 60 horsepower units		
■ ■	Hydraulic, 10 micron, 9.40 long, spin on, 60,000/90,000psi-4.100/6.200 bar	05104187	
	For 75 to 200 horsepower units		

O-RINGS FOR SEALING HEADS

DESCRIPTION

PART No.

O-Ring - 131, 1.69 x 1.88 x 0.09, Buna-N, D-70

10146082

90,000psi/6.200 bar

Used on all PRO-I units,
Used on sealing head 20480113



O-Ring, Metric, 3MM x 1XX, Buna-N, D-70

05049853

60,000psi/4.100 bar

Used on SL-IV units
Used on sealing head 05116769



O-RINGS FOR PNEUMATIC VALVES

O-Ring - 035, 2.25 x 2.38 x 0.06, Viton, D-75

10074565

Used on all 60,000/90,000psi-4.100/6.200 bar
N/O pneumatic actuator assemblies



O-Ring - 143, 2.44 x 2.63 x 0.09, Viton, D-75

10074714

Used on all 60,000/90,000psi-4.100/6.200 bar
N/O pneumatic actuator assemblies



O-Ring - 038, 2.63 x 2.75 x 0.06, Viton, D-70

10177806

Used on all 60,000/90,000psi-4.100/6.200 bar
N/C pneumatic actuator assemblies



O-Ring - 044, 0.08 x 0.20 x 0.06, Viton, D-75

49895584

Used on all 60,000/90,000psi-4.100/6.200 bar
N/C pneumatic valve assemblies



O-RINGS FOR TOPWORKS

DESCRIPTION

PART No.

- O-Ring - 344, 3.88 x 4.25 x 0.19, Buna-N, D-90A**
90,000psi/6.200 bar
 Used on all PRO-III units
 Used on hydraulic cylinder head
- O-Ring - 115, 0.69 x 0.88 x 0.09, Buna-N, D-70**
90,000psi/6.200 bar
 Used on the proximity switch of all PRO units
- O-Ring - 218, 1.25 x 1.50 x 0.13, Polyurethane, D-70, 60,000/90,000psi-4.100/6.200 bar**
 Used on all hydraulic piston assemblies
- O-Ring - 252, 5.25 x 0.5 x 0.13, Viton, D-75, 60,000/90,000psi-4.100/6.200 bar**
 Used on all SL-V and SL-VI (PRO) units with a 75 (PRO: 60) to 200 horsepower rating
 Used on hydraulic cylinder head
- O-Ring - 132, 1.75 x 1.94 x 0.09, Buna-N, D-70**
60,000psi/4.100 bar
 Used on all SL-V, SL-VI and NL-I units
 O-Ring for LP water inlet
- O-Ring - 214, 1.0 x 1.25 x 0.13, Buna-N, D-70**
60,000psi/4.100 bar
 Used on all OEM 50 units and all SL-V and NL-I units with a 15 to 60 horsepower rating
 Used on intensifier support

72176756



05144191



05087713



10074771



10074920



10074409



O-RINGS FOR TOPWORKS

DESCRIPTION



**O-Ring - 240, 3.75 x 4.0 x 0.13,
Buna-N, D-70. 60,000psi/4.100 bar**

Used on all SL-IV, SL-V, SL-VI and NL-I units with a 15
to 60 horsepower rating
Used on hydraulic cylinder head



**O-Ring - 129, 1.56 x 1.75 x 0.09,
Buna-N, D-70. 60,000psi/4.100 bar**

Used on all SL-IV units
O-Ring for LP water inlet

PART No.

10075000

10074904



Since 1971, we are proud to be the pioneers of waterjet
technology, located in the Heart of America, Baxter Springs, KS.

We specialize in the design & manufacturing of waterjet
cutting pumps & technology and are dedicated to helping
our customers grow & accelerate their businesses.



O-RINGS FOR CUTTING HEADS

DESCRIPTION

PART No.

 **O-Ring - 012, 0.38 x 0.50 x 0.06, Buna-N, D-70. 90,000psi/6.200 bar**
 Used on wear insert for AUTOLINE PRO cutting head assemblies

05077078



 **O-Ring - 011, 0.31 x 0.44 x 0.06, Aflas, D-70**
 AUTOLINE II & AUTOLINE PRO cutting head assemblies, **60,000/90,000psi-4.100/6.200 bar pumps**. Used in wear insert 20453064

20445476



 **O-Ring - 018, 0.75 x 0.88, Polyurethane, D-70. 90,000psi/6.200 bar**
 AUTOLINE PRO cutting head assemblies
 Used in cap 20480732

05142286



 **O-Ring, 0.69 x 0.81 x 0.06**
 AUTOLINE II & AUTOLINE PRO cutting head assemblies, **60,000/90,000psi-4.100/6.200 bar pumps**
 Used in nozzle body 20480715 & 20453958

05138821



 **O-Ring - 013, 0.44 x 0.56 x 0.06, Buna-N, D-70**
 Used on Abrasive Inlet Adapter
 Used on IDE II & IDE PRO cutting heads
60,000/90,000psi-4.100/6.200 bar pumps

10074870



 **O-Ring - 012, 0.38 x 0.50 x 0.06, Polyurethane, D-70. 60,000psi/4.100 bar**
 Used on AUTOLINE I & AUTOLINE II cutting head assemblies
 Used in cap 20453952 & 05076971
60,000psi/4.100pumps

05081518



 **O-Ring - 016, 0.63 x 0.75 x 0.06, Polyurethane, D-70. 60,000psi/4.100 bar**
 Used on AUTOLINE I cutting head assemblies
 Used in nozzle body 05073820

05092887



 **O-Ring - 014, 0.50 x 0.63 x 0.06, Polyurethane, D-70. 60,000psi/4.100 bar**
 Used on AUTOLINE I cutting head assemblies

05104930



O-RINGS FOR INLINE FILTERS

DESCRIPTION

PART No.

- O-Ring - 012, 0.38 x 0.50 x 0.06, Viton, D-75. 60,000psi/4.100 bar**
Used in 49893555 Filter Assembly

10074599



BOOSTER PUMPS

Booster Pump, Stainless Steel, CW ROT

200psi/14 bar, 1.33 gpm. 90,000psi/6.200 bar
Used on PRO units with a 60 horsepower rating

20481206

115psi/8 bar, 3.13 gpm
Used on all SL-V 60,000psi and PRO 90,000psi units
with a 75 to 125 horsepower rating

49836778

200psi/14 bar, 1.33 gpm
Used on all SL-V 60,000psi units with a 15 to
60 horsepower rating

49887094

200psi/14 bar, 1.33 gpm
Used on all SL-V 60,000psi units with a 15 to
60 horsepower rating and temperature probe

05071659



HOSES

Polyurethane Tubing - 0.38, Clear

60,000/90,000psi-4.100/6.200 bar

49885361

Push-on Hose - 0.50, 290psi/20 bar, Blue

60,000/90,000psi-4.100/6.200 bar

20421272

PVC Tubing - 0.50 x 0.748, Reinforced, Static-free

60,000/90,000psi-4.100/6.200 bar

05076963

Flexible Tubing - 0.50, Nylon

60,000/90,000psi-4.100/6.200 bar

05044532



All dimensions in inch unless specified otherwise.

Order online 24/7: kmtgenuineparts.com

GAUGES

DESCRIPTION

Pressure Gauge - 0-15,000psi/0-10.300 bar

0.38 HP, Flush Mount, 6" Face, Glycerin filled
 For use on 90,000psi/6.200 bar pumps
 Requires 20464745 Adapter

Pressure Gauge - 0-20psi/0-14 bar. Used on 60,000/90,000psi-4.100/6.200 bar pumps

0.25 NPT, back mount, Stainless Steel

Pressure Gauge - 0-5,000psi/0-350 bar

0.25 bottom mount. For use on 60,000psi/4.100 bar pumps
 For 0.88 plungers, SL-IV and SL-V 60,000psi/4.100 bar pumps

Pressure Gauge -0-100,000psi/ 0-6.900 bar

0.25 HP, 4.25" Face, bottom mount. For use on 60,000psi/4.100 bar pumps
 For use on 60,000psi/4.100 bar pumps

Pressure Gauge - 0-100,000psi/ 0-6.900 bar, 60,000psi/4.100 bar pumps

0.25 HP, Bottom Mount. 6" Face, Glycerin filled
 For use on 60,000psi/4.100 bar pumps

PART No.

20467883



05139506



05045497



20443831



05125836

ELECTRICAL COMPONENTS

DESCRIPTION	PART No.	
<p> Solenoid Valve - 24V DC 60,000psi/4.100 bar .13, 2-3 Way, 2 Pos</p>	49888035	
<p> Output Module - Single Point 60,000/90,000psi-4.100/6.200 bar 24V DC, 3 amp</p>	10146363	
<p> Inlet Pressure Switch, 2 bar 60,000/90,000psi-4.100/6.200 bar Stainless Steel</p>	05140751	
<p> Valve Proportional Pressure Control 60,000/90,000psi-4.100/6.200 bar</p>	80071087	
<p> Proportional Control Assembly Kit 60,000/90,000psi-4.100/6.200 bar Including Valve (80071087) and installation material</p>	05121987	
<p> Directional Control Valve - Electric 24V DC, D03, 4-way, 60,000psi/4.100 bar</p>	05017553	
<p> Directional Control Valve Assembly, 24V DC, D08, 0.055 orifice For SL-IV & SL-V 60,000psi/4.100 bar - 30, 50, 60 horsepower intensifiers</p>	20437164	
<p> Knob Adjuster 60,000psi/4.100 bar. Used on all Hydraulic Cartridge Valve Assemblies Pressure Relief, 17-207 bar, SL-V, Classic and OEM units</p>	10187052	
<p> Water Modulating Valve, 60,000psi/4.100 bar</p>	10091866	

All dimensions in inch unless specified otherwise.

Order online 24/7: kmtgenuineparts.com

LIGHT BULBS

DESCRIPTION



Light Bulb 24V, 2.0 Watt

60,000/90,000psi-4.100/6.200 bar. For use with Klockner Moeller Switches



Light Bulb 24V AC/DC

60,000/90,000psi-4.100/6.200 bar

For AB 800F

PART No.

05050216



20484737



PRESSURE TRANSDUCERS



UHP Pressure Transducer

0-90,000psi/0-6.200 bar



Pressure Transducer

0-75,000psi/0-5.200 bar



PICO Fuse- Input/Output

60,000/90,000psi-4.100/6.200 bar

20478335



49838478



49885866



TOPWORKS TOOLS

	DESCRIPTION	PART No.
	Hydraulic Tensioner Assembly, PRO Intensifier 90,000psi/6.200 bar	20476132
	Cylinder Clamp, PRO Intensifier 90,000psi/6.200 bar	20476495
	Vee Block Cradle 60,000/90,000psi-4.100/6,200 bar	20484961
	HP Seal Removal Tool	
	0.88 Plunger, 60,000/90,000psi-4.100/6.200 bar	10148674
	1.13 Plunger, 60,000psi/4.100 bar	05146618
	Plunger Removal Tool	
	0.88 Plunger, 60,000/90,000psi-4.100/6.200 bar	20477460
	1.13 Plunger, 60,000psi/4.100 bar	20477469
	Plate Glass Pane 8.0 x 8.0 x 0.25	10149052
	Emery Cloth 320 Grit, 9.0 x 11.0 400 Grit, 9.0 x 11.0 600 Grit, 9.0 x 11.0	10149029 10149037 10149045



TOPWORKS TOOLS

DESCRIPTION

PART No.

- Cylinder Wrench**
 90,000psi/6,200 bar - PRO 2 Units
- Cylinder Wrench**
 60,000psi/4,100 bar
- Crowfoot Wrench** - 60,000psi/4,100 bar
 1.625, 0.38 drive
- HP Seal Removal Tool Stand**
 60,000psi/4,100 bar
- End Cap Wrench**
 60,000psi/4,100 bar, 6x/8x, HSEC

20490232

05066139

20477489

80078330

80079239



Check out the
 OVER 200
 CUTTING VIDEOS
 on the KMT
 YouTube Channel



...and our other social media channels

LUBRICANTS

DESCRIPTION

60,000/90,000psi-4.100/6.200 bar Pumps

PART No.



Pure Goop Thread Lubricant

1.0 pound

05026281



Pure Goop Thread Lubricant

1.0 ounce

10084440



NLGI-2 Swivel Grease

14.0 ounce

10067189



FML-2 Grease - FDA Approved

14.5 ounce

10087385



Super-O-Lube O-Ring Grease

0.07 ounce

20485968



Threadlocker Adhesive

242, 0.50 ML

20487868



Threadlocker Primer

1.75 ounce

20494983



JL-M Thread Lubricant

16.0 ounce

49832199



Loctite Thread Lubricant

8.0 ounce

1011919





THE VALUE OF PRO 90,000 PSI



WHY PAY MORE TO CUT LESS PARTS?

The charts below illustrate how abrasive usage and cutting time results* in the lowest cost per part when cutting at 90,000psi versus 60,000psi. *Results from KMT Waterjet Cut Calculator App



**1" ALUMINUM
 94.5" CUT LENGTH**



KMT PUMPS	SERIES	HP	PSI	CUT TIME (MINUTES)	ABRASIVE USAGE (POUNDS)	COST PER PART*	HIGHEST COST PER PART
	SL	50	60,000	13.25	18.95	\$19.00	 HIGHEST COST PER PART LOWEST COST PER PART
	PRO	60	90,000	9.37	10.11	\$13.48	
KMT PRO ADVANTAGE >>>				3.48 min. Faster Cutting	8.84 lbs. Less Abrasive	\$5.52 Savings	

* Includes operating costs, utilities & labor (as of May 2023)

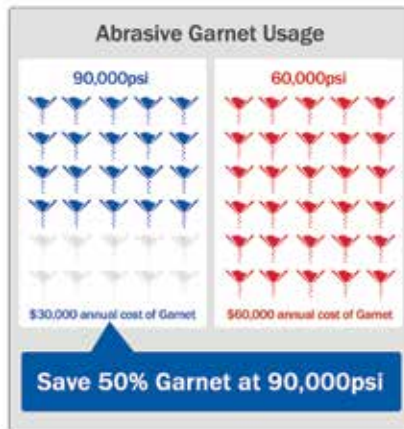
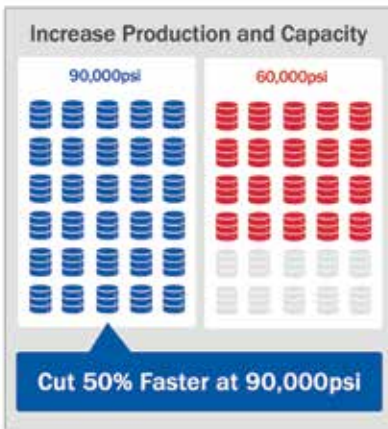



FREQUENTLY ORDERED KMT GENUINE PARTS

Description	Part No.

NOTES

Check out our **MONTHLY SPECIALS**

(kmtwaterjet.com/promotions)

- KMT Pumps Savings
- KMT Parts Specials
- KMT Service Offers
- Financing Deals



KMT SERVICE PLEDGE TO OUR CUSTOMERS

Our loyal customers are extremely important to the people that make up our sales and service teams.

Our accomplishments are measured by the highest quality of positive involvement we can provide before, during and after the purchase of our products.

By offering more value with consistent, favorable past and present experiences in every aspect of every interaction, we strive to continue to earn your faith, and gain new, loyal customers.



SINCE 1963, KMT HAS BEEN AT THE HEART OF ULTRA HIGH-PRESSURE (“UHP”) PUMP TECHNOLOGY.

We specialize in the design and manufacture of waterjet cutting pumps and technology, and are dedicated to helping our global customers accelerate their businesses with ultra high-pressure. We're committed to pairing our cutting edge technology with impeccable service, so you can focus on growing your business.

KMT. A GLOBAL FORCE IN WATERJET TECHNOLOGY

BACKED BY KMT PREVENTIVE MAINTENANCE PROGRAMS

Our Global KMT Genuine Service Engineers are highly qualified, averaging 15+ years of waterjet experience.



kmtgenuineparts.com

KMT Waterjet Systems Inc.
635 West 12th Street | Baxter Springs | KS 66713
800 826 9274 | kmtwaterjet.com

